

Item	Qty	Part Number	Description
1	1	HYP-9306S-HM5C	Stainless Steel Hydraulic Water Pump
2	1	PPF-ADP-32FLX32MP	2" Full Port Flange x 2" MPT Adaptor
3	2	PPF-CPL-48FLX32FL	3" Flange x 2" Full Port Flange Coupler
4	1	PPF-TEE-48FL	3" Flange Tee
5	1	PPF-V2B-32FLX32MQD	2" Full Port Flange Bolted Ball Valve
6	1	PPF-FQD-32X	2" Camlock Cap
7	1	PPF-V2B-48FL	3" Flange Ball Valve Bolted
8	1	PPF-SBR-48BX48FL	3" Flange Hose Barb
9	1	PPF-9BR-48BX48MP	3" 90° Hose Barb
10	1	PPF-BHD-48-BOLTED-BD	3" Poly Bottom Drain Bolted Bulkhead
11	2	PPF-BJO-32-CLAMP	2" Full Port Flange Screw Clamp
12	2	PPF-BJO-32-GASKET	2" Full Port EPDM Gasket
13	4	PPF-BJO-48-CLAMP	3" Full Port Flange Screw Clamp
14	4	PPF-BJO-48-GASKET	3" Full Port EPDM Gasket
15	4'	HSE-7226-48	3" Low Temp Suction Hose
16	4	PPF-BJO-48-HOSECLAMP	3" Banjo HD Hose Clamp

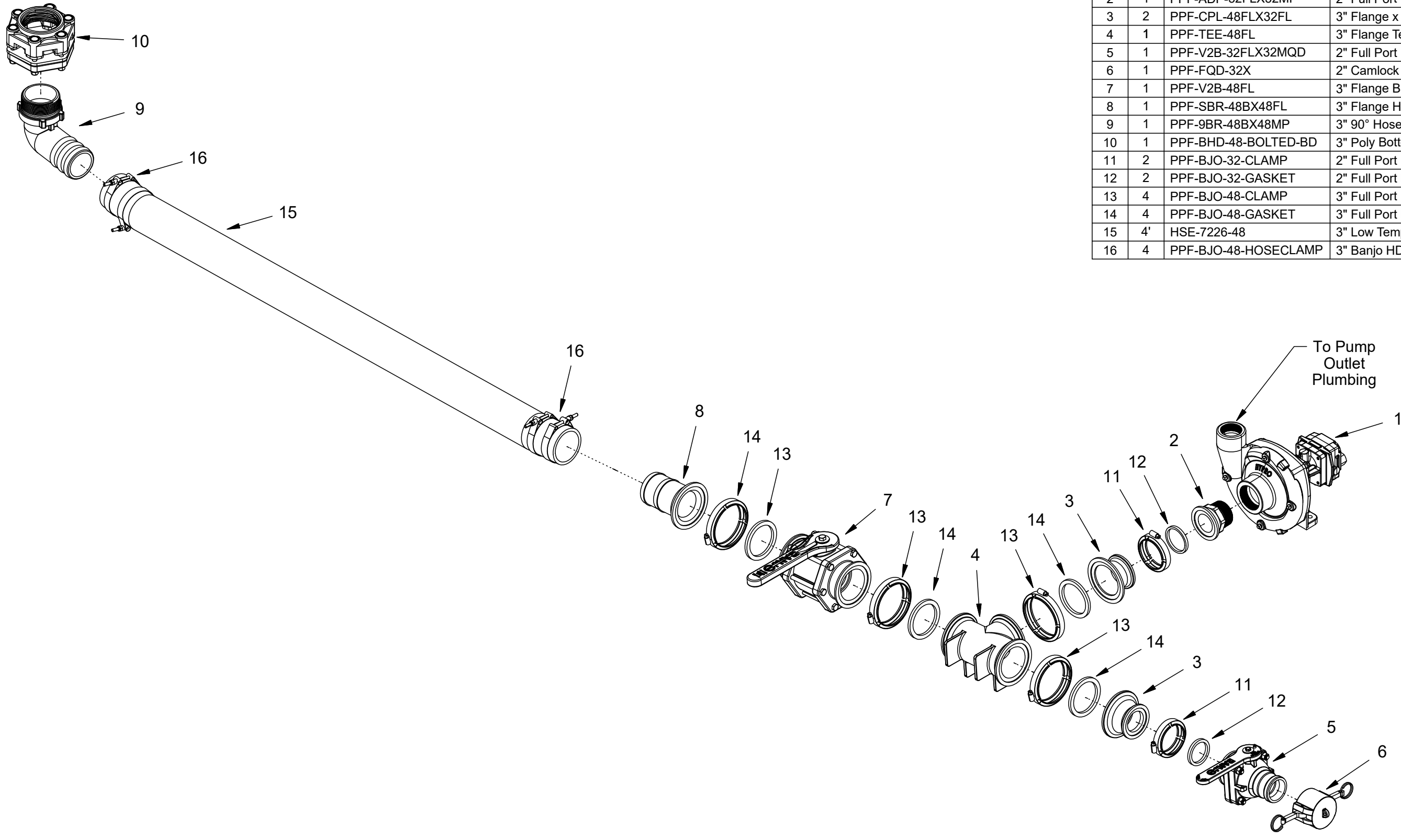

To Pump
Outlet
Plumbing

		2302 A St. S.E. Auburn WA 98002	
TITLE: 3" HYDRAULIC ANTI-ICE INLET PLUMBING			
DRAWN BY: J GOULET	CHECKED BY:	SCALE:	PAGE: 1/1
DATE CREATED: 1/3/14	DRAWING NUMBER: ASM-7005-V3	DATE REVISED:	