

Item	Qty	Part Number	Description
1	1	ASM-3241-V2	Skid Suction Bulkhead
2	1	PPF-9EL-24FP	1 1/2" Poly 90° Elbow
3	2	PPF-SBR-24BX24MP	1 1/2" Poly Hose Barb
4	1	PPF-V2B-24FP	1 1/2" Poly Ball Valve
5	1	PPF-MQD-24MP	1 1/2" Poly Male Camlock
6	1	PPF-FQD-24MP	1 1/2" Poly Female Camlock
7	1	PPF-TEE-24FP	1 1/2" Poly Tee
8	2	PPF-ADP-24FLX24MP	2" Std Port x 1 1/2" Male Adapter
9	1	PPF-BJO-24-CLAMP	2" Std Port Flange Screw Clamp
10	1	PPF-BJO-24-GASKET	2" Std Port EPDM Gasket
11	1	HYP-9303C-HM4C	Hypro Hydraulic Water Pump
12	1	PPF-BSH-24MPX12FP	1 1/2" x 3/4" Poly Bushing
13	1	BRF-HXN-12MPX8MP	3/4" x 1/2" Brass Hex Nipple
14	1	BRF-CRS-08FP	1/2" Brass Cross
15	1	BRF-BSH-08MPX06FP	1/2" x 3/8" Brass Bushing
16	1	NHP-36946	1/4" x 3/8" 90° Air Fitting
17	1	NHP-36942	1/4" x 1/8" 90° Air Fitting
18	1'	NHP-39251	1/4" DOT Air Line
19	2	SPR-5421	1/8" Drain Cock
20	5'	HSE-7225-24	1 1/2" PVC Suction Hose
21	4	FAS-7655-24	1 1/2" Hose Clamps

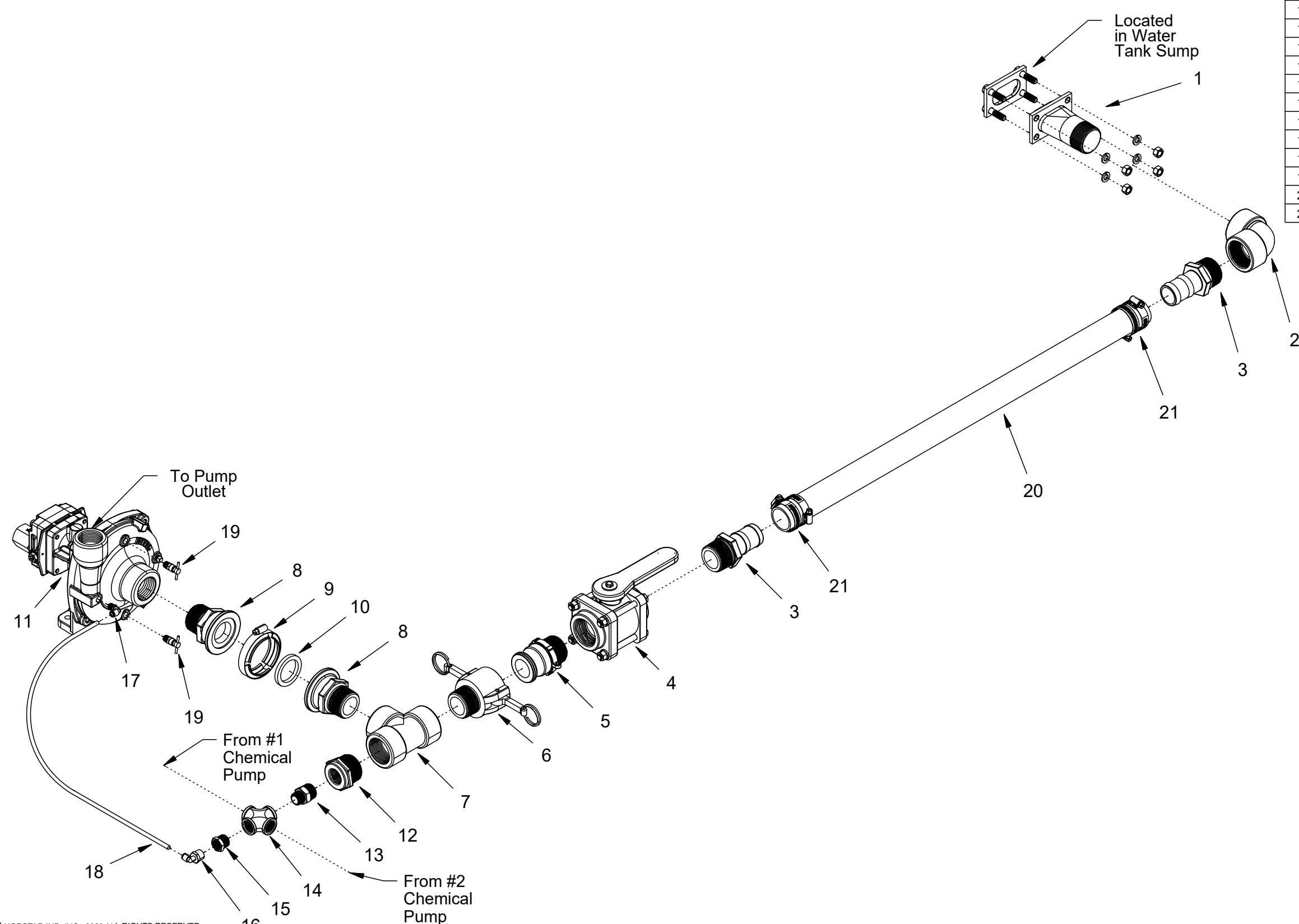

<b>NORSTAR</b> INDUSTRIES, INC.		2302 A St. S.E. Auburn WA 98002	
TITLE: <b>WATER PUMP INLET PLUMBING</b>			
DRAWN BY: <b>J GOULET</b>	CHECKED BY:	SCALE:	PAGE: <b>1/1</b>
DATE CREATED: <b>6/8/07</b>	DRAWING NUMBER: <b>ASM-1012-V3-HYD</b>	DATE REVISED: <b>5/31/19</b>	