

Item	Qty	Part Number	Description
1	1	ASM-3241-V2	Skid Suction Bulkhead
2	1	PPF-9EL-24FP	1 1/2" Poly 90° Elbow
3	2	PPF-SBR-24BX24MP	1 1/2" Poly Hose Barb
4	1	PPF-V2B-24FP	1 1/2" Poly Ball Valve
5	1	PPF-MQD-24MP	1 1/2" Poly Male Camlock
6	1	PPF-FQD-24MP	1 1/2" Poly Female Camlock
7	1	PPF-TEE-24FP	1 1/2" Poly Tee
8	2	PPF-ADP-24FLX24MP	2" Std Port x 1 1/2" Male Adapter
9	1	PPF-BJO-24-CLAMP	2" Std Port Flange Screw Clamp
10	1	PPF-BJO-24-GASKET	2" Std Port EPDM Gasket
11	1	PPF-BSH-24MPX12FP	1 1/2" x 3/4" Poly Bushing
12	1	BRF-HXN-12MPX8MP	3/4" x 1/2" Brass Hex Nipple
13	1	BRF-CRS-08FP	1/2" Brass Cross
14	1	BRF-BSH-08MPX06FP	1/2" x 3/8" Brass Bushing
15	1	NHP-36946	1/4" x 3/8" 90° Air Fitting
16	1	NHP-36842	1/4" x 1/8" Str. Air Fitting
17	1'	NHP-39251	1/4" DOT Air Line
18	1	BRF-NIP-02MP	1/4" Brass Nipple
19	1	BRF-TEE-02FP	1/4" Brass Tee
20	2	SPR-5421	1/8" Drain Cock
21	5'	HSE-7225-24	1 1/2" PVC Suction Hose
22	4	FAS-7655-24	1 1/2" Hose Clamps

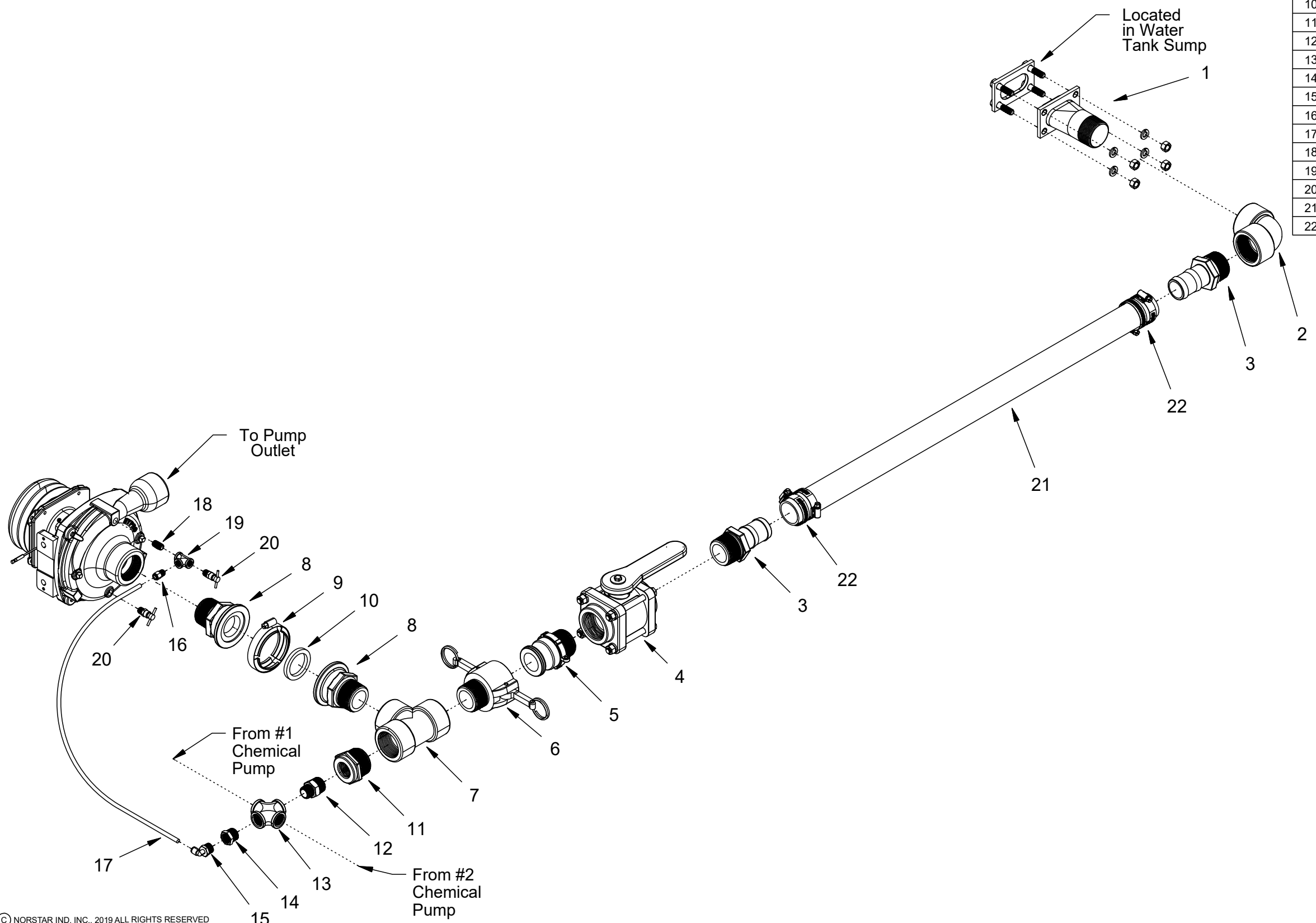

NORSTAR INDUSTRIES, INC.		2302 A St. S.E. Auburn WA 98002	
TITLE: WATER PUMP INLET PLUMBING			
DRAWN BY: J GOULET	CHECKED BY:	SCALE:	PAGE: 1/1
DATE CREATED: 6/8/07	DRAWING NUMBER: ASM-1012-V3 - GAS	DATE REVISED: 5/31/19	